

CUT OFF SAW

SDS-2200

No.:000495 230 V

No.:002437 127 V

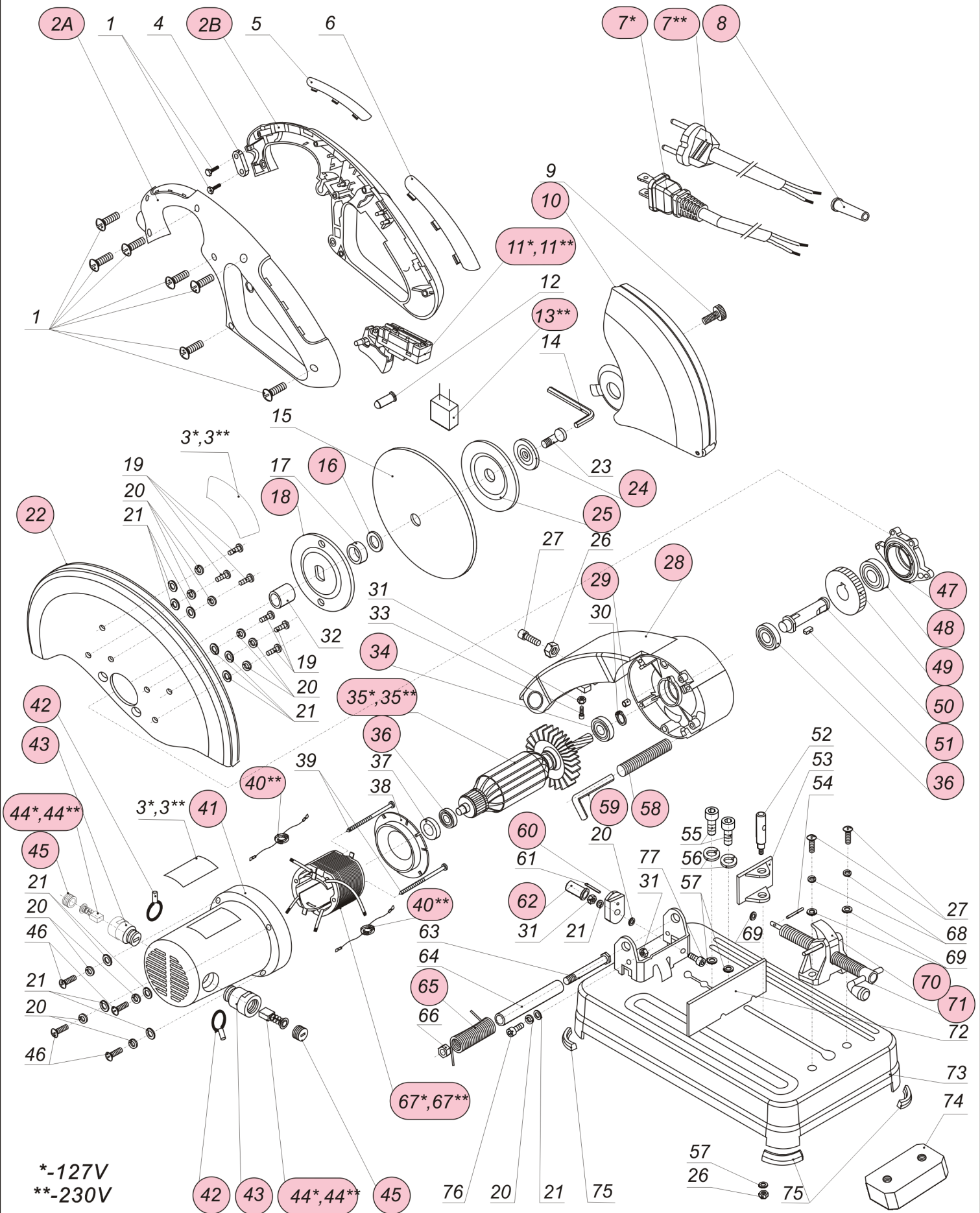

*-127V
**-230V

DWTFeb 2003
DIYCUT OFF SAW
SDS - 2200Model No.: 000495 - 230 V
002437 - 127 V**PRICE LIST OF SPARE PARTS**

Pos.	Part Number	Description (Q-ty)	Description National Language (Q-ty)	Price, USD
1	A1-2085/22	Screw ST4x16 (9)		
2A	A1-0761/01	Handle A		
2B	A1-0761/02	Handle B		
3*	A1-0781/50	Name plate (2) 127V		
3**	A1-0781/51	Name plate (2) 230V		
4	A1-0081/54	Cord clip		
5	A1-0781/52	Soft grip A		
6	A1-0781/53	Soft grip B		
7*	C1-0934/01	Cord 127V		
7**	B1-0934/01	Cord 230V		
8	A1-0187/62	Rubber sleeve		
9	A1-2081/39	Screw M6x10		
10	A1-0781/54	Moving guard		
11*	C1-0731/01	Switch 127V		
11**	B1-0731/01	Switch 230V		
12	A1-0781/55	Switch button		
13**	B1-0941/02	Condenser 0.33 μ F 230V		
14	A1-0781/56	Spanner		
15	A1-0781/57	Cutting wheel		
16	A1-0781/58	"O"-ring \varnothing 14x1,8		
17	A1-0781/59	Bush \varnothing 25x \varnothing 17x6		
18	A1-0781/60	Inner flange		
19	A1-2081/15	Screw M4x18 (6)		
20	A1-2083/32	Spring washer \varnothing 4 (12)		
21	A1-2083/01	Washer \varnothing 4 (12)		
22	A1-0781/61	Fixed guard		
23	A1-2081/74	Socket screw M10x20		
24	A1-0781/62	Small flange		
25	A1-0781/63	Outer flange		
26	A1-2082/29	Nut M8 (2)		
27	A1-2081/49	Screw M8x30 (3)		
28	A1-0781/64	Bracket		
29	A1-2084/40	Rubber pole \varnothing 6x16		
30	A1-0083/08	Circlip for shaft \varnothing 15		
31	A1-2082/13	Nut M4 (3)		
32	A1-0781/65	Bush \varnothing 23x \varnothing 17x15		
33	A1-2081/32	Screw M5x30		
34	A1-0915/01	Ball bearing 6202.RS		
35*	C1-0701/01	Armature 127V		
35**	B1-0701/01	Armature 230V		
36	A1-0908/01	Ball bearing 6000.RS (2)		
37	A1-0781/66	Bearing bush \varnothing 32x \varnothing 26x9		
38	A1-0781/67	Guide wind circle		
39	A1-2085/53	Screw ST5x80		
40**	B1-0941/03	Inductor \varnothing 10x \varnothing 6x3.5 (2) 230V		
41	A1-0761/03	Housing		
42	A1-0781/01	Connection spring \varnothing 20		
43	A1-0781/02	Brush holder (2)		
44*	C1-0967/01	Carbon brush (2) 127V		
44**	B1-0967/01	Carbon brush (2) 230V		
45	A1-0781/03	Brush cap (2)		
46	A1-2081/17	Screw M4x38 (4)		
47	A1-0781/04	Bearing holder		
48	A1-0916/01	Ball bearing 6203.RS		

Pos.	Part Number	Description (Q-ty)	Description National Language (Q-ty)	Price, USD
49	A1-0746/01	Big gear		
50	A1-0781/05	Spindle		
51	A1-0781/06	Key 6x14		
52	A1-0781/68	Impaction pin		
53	A1-0781/69	Small impaction board		
54	A1-0781/70	Retainer pin 2x20		
55	A1-2081/75	Socket screw M10x25		
56	A1-2083/36	Spring washer Ø10 (2)		
57	A1-2083/10	Washer Ø10 (3)		
58	A1-2084/10	Spring Ø 8x40		
59	A1-0781/71	Brake pin		
60	A1-0781/72	Location block		
61	A1-2084/34	Pin 3x10		
62	A1-0781/73	Location block handle		
63	A1-2081/57	Screw M12x125		
64	A1-0781/74	Hollow shaft		
65	A1-0781/07	Big spring		
66	A1-2082/36	Nut M12		
67*	C1-0716/01	Stator 127V		
67**	B1-0716/01	Stator 230V		
68	A1-2083/35	Spring washer Ø8 (2)		
69	A1-2083/07	Washer Ø8 (3)		
70	A1-0781/75	Lock nut set		
71	A1-0781/76	Impaction screw		
72	A1-0781/77	Big impaction board		
73	A1-0781/78	Base set		
74	A1-0781/79	Balance block		
75	A1-0781/80	Rubber pad (4)		
76	A1-2081/13	Screw M4x15		
77	A1-2081/16	Screw M4x20		